

# STUART TURNER LTD HENLEY-ON-THAMES.

THIRD ANGLE PROJECTION

DIMENSIONS IN MILLIMETRES

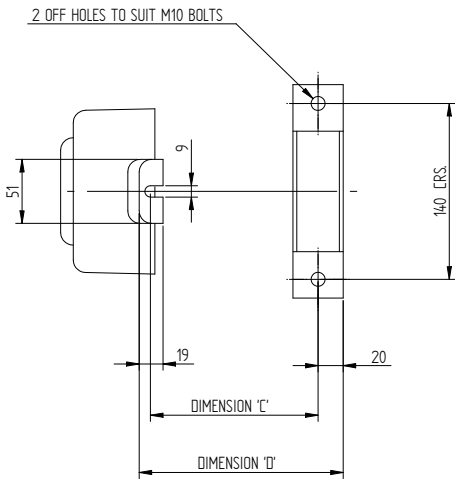

MODEL	DIMENSION			
	'A'	'B'	'C'	'D'
MONSOON EXTRA U3.0 BAR	222	77,5	107,5	137
MONSOON EXTRA U3.5 BAR	246	101,5	131,5	161

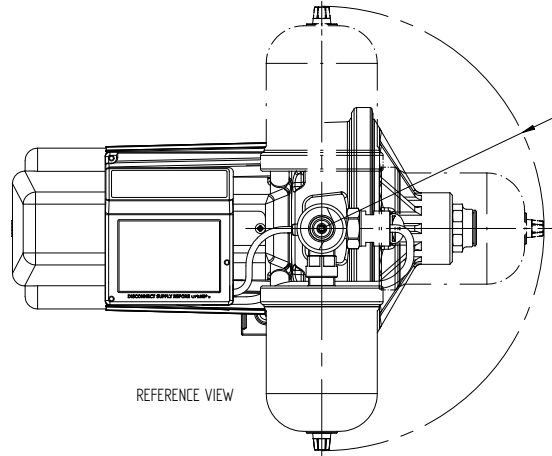

NOTE:  
THE PRESSURE VESSEL CAN BE RE-POSITIONED IF REQUIRED TO SUIT SPECIFIC INSTALLATIONS, HOWEVER, CARE MUST BE TAKEN WHEN RE-POSITIONING TO ENSURE NO STRAIN IS PLACED UPON THE PRESSURE SWITCH OR FLOW SWITCH CABLES.

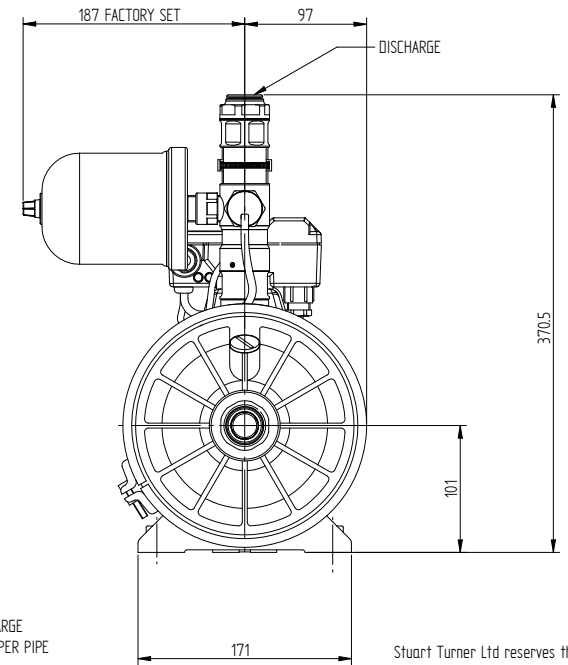
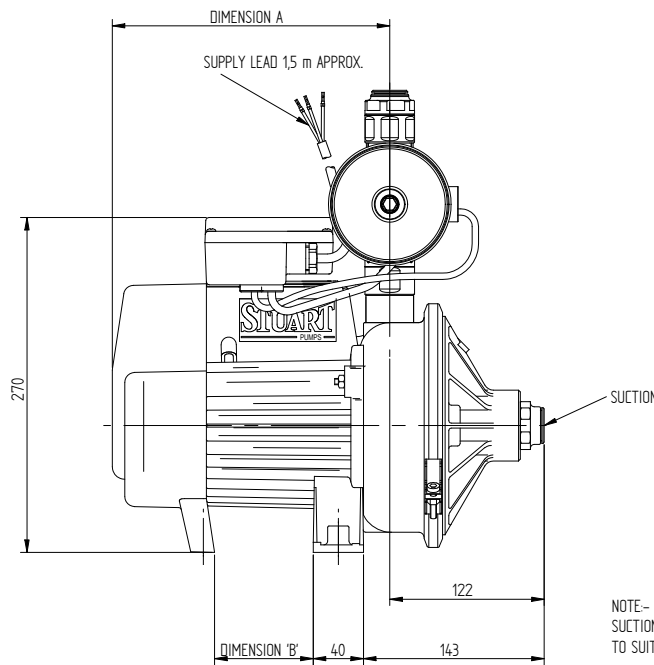

NOTE-  
SUCTION AND DISCHARGE  
TO SUIT 22 mm COPPER PIPE

Stuart Turner Ltd reserves the right to amend specifications without notice.

If drawing is to be used for constructional purposes please contact Stuart Turner Ltd and request a certified document.

Stuart Turner Ltd own the copyright within this document. The document may be printed for personal use only. The document must not be altered, reproduced or utilized in any way without written permission from Stuart Turner Ltd, Henley-on-Thames, Oxon, UK.

## GENERAL ARRANGEMENT OF A MONSOON EXTRA U3.0 & 3.5 bar SINGLE

W41341

DATE: 02/03/2010